

SYMBOL	MILLIMETER		
	MIN	NOM	MAX
A	2.20	2.30	2.40
A1	0.00	--	0.10
b	0.66	0.76	0.86
c	0.46	0.51	0.58
D	6.50	6.60	6.70
D1	5.10	5.33	5.46
D2	4.83 REF.		
E	6.00	6.10	6.20
e	2.19	2.29	2.39
L	9.80	10.10	10.40
L1	2.90 REF.		
L2	1.40	1.50	1.60
L3	1.80 REF.		
L4	0.60	0.80	1.00
L5	0.90	--	1.25
Φ	1.10	--	1.30
θ	0°	--	8°
V	5.35 REF.		

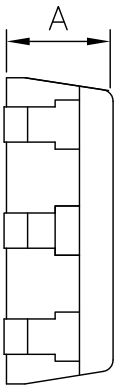

技术说明:

1) LEADFRAME MATERIAL: COPPER;

引线框架材料: 铜;

2) LEADFRAME THICKNESS: 0.508mm;

引线框架厚度: 0.508mm;

3) BOTH PACKAGE LENGTH AND WIDTH DO NOT INCLUDE MOLD FLASH;

塑封体长度及宽度尺寸不包括塑封溢胶;

4) REFERENCE: JEDEC MS-013, MS-012.

参考标准: JEDEC MS-013, MS-012.

NO.	NAME	Q'TY	MATERIAL	DIMENSION	FINISH	HARDING	REMARK
	THIRD ANGLE PROJECTION			UNIT: mm	TITLE: TO-252-3L产品成型图		
	TOLERANCE		DESIGNER: 冯玲	DATE: 2018-03-28	CHECKER:	APPROVER:	DWG. NO: MT-P0-011
			2018-03-28				VERSION: A